

## **Cedar Trim Kit to conceal control cables** **(Provide with Tylo Plus and Combi heaters)**

### **Pre-Fab Sauna with Tylo Pure or Elite Control - Mounted Inside**

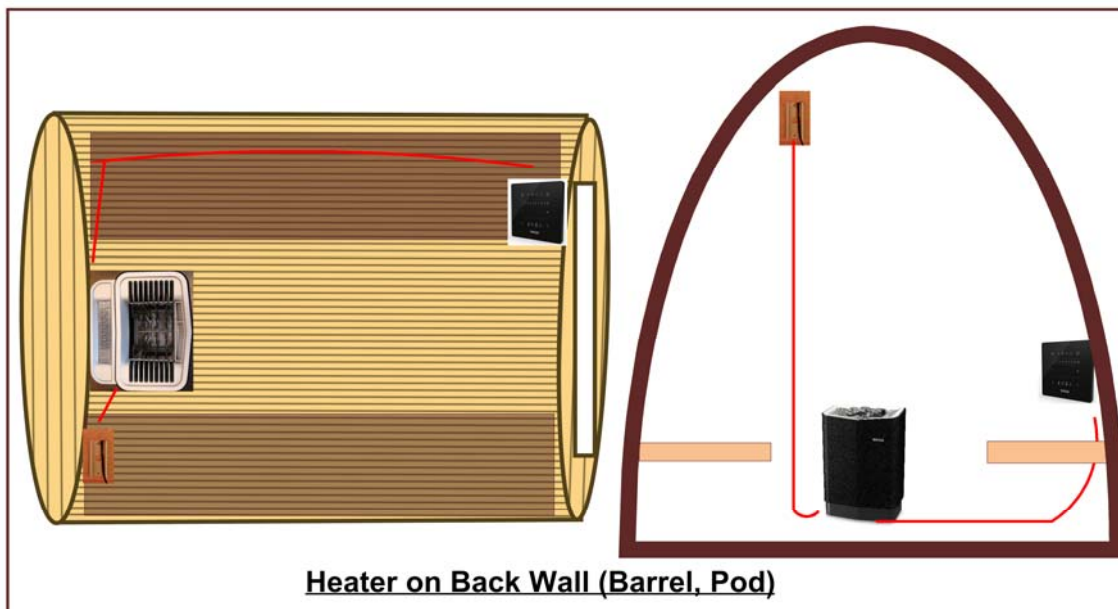

**Heater on Back Wall (Barrel, Pod)**

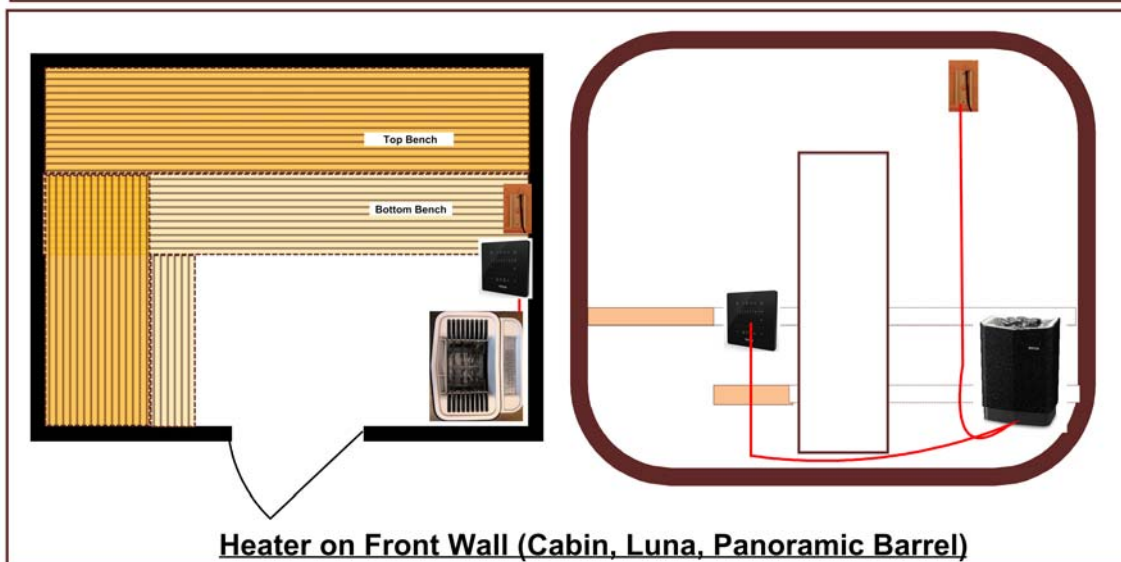

**Heater on Front Wall (Cabin, Luna, Panoramic Barrel)**

### **Prefab sauna with TYLO Plus or Combi**

**Control is mounted inside sauna. Control must be mounted at least 1' from heater and no more than 3' above floor.**

**Mount sensor 1" from ceiling, 3" away from heater (not in corner).**

#### **Heater on Back Wall (Barrel, Pod)**

**Control:** Run cable under bench up through bench gap to 3' above floor.

**Mount control** above bench on back or front wall. (3' above floor).

#### **Heater on Front Wall (Cabin, Luna, Panoramic barrel)**

**Control:** Run cable under door to front wall or on side wall (1- min. away from heater).

(Maximum 3' above floor)

#### **Sensor:**

**Sensor wire up** goes high on wall next to heater- 1" down from ceiling (not in the corner).

**Surface install sensor** as shown in heater QSG (quick start guide)

**Trim:** Cedar trim provided. Cut to size as and use as desired

## Example of Tylo Control Inside Installation



## Example of Tylo Sensor Location & Trim

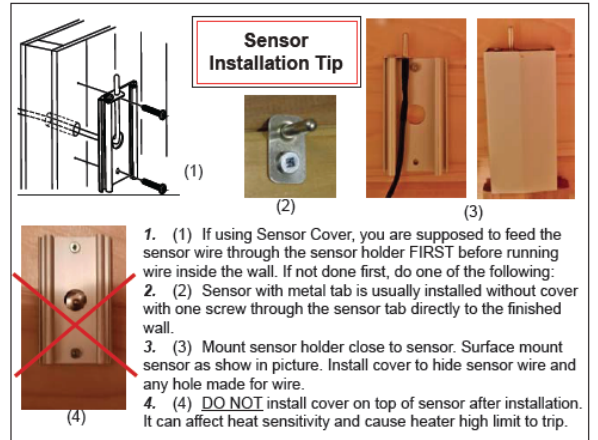

## Temperature Sensor Location

Sensor location is very specific and very important for proper function of the sauna heater. Sensor must be 3" to the front or open side of heater (not in corner), 1" down from ceiling.

