

SaunaLogic App Quick Start Guide:

How to Pair **SL2/IS-SL2/SL2-C/IL2** Control to SaunaLogic App

All controls are referenced as SL2 in this document.

SL2, IS-SL2, SL2-C, and IL2 each use the same pairing process.

Control faces will vary in looks by product type.

Control displayed is the IS-SL2.



The SaunaLogic App allows you to turn your sauna on/off, set temperature, turn on Bluetooth, adjust lighting, and more from the convenience of your smart phone or tablet. These instructions walk through the steps to pair the SL2 Control to the SaunaLogic App.

Table of Contents

How to Pair your Apple Device (iOS) 2

How to Pair your Android Device (Android OS) 7

NOTICE: THE SAUNA HEATER AND SL2 CONTROL MUST BE INSTALLED AND OPERATIONAL PRIOR TO PAIRING TO THE SAUNALOGIC APP. REFER TO THE INSTALLATION INSTRUCTIONS SPECIFIC TO THE HEATER MODEL YOU HAVE FOR INSTALL REQUIREMENTS.

1) Download the SaunaLogic App and install onto your smart phone or tablet by scanning the appropriate QR Code below or by searching for “SaunaLogic” in the appropriate app store for your smart device.



2) Register a New Account: When you open the SaunaLogic App for the first time, you will be given the option to Register or Login with Existing Account. You will need to select Register and follow the prompts to complete the registration requirements. A valid email address will be required to complete the registration process.

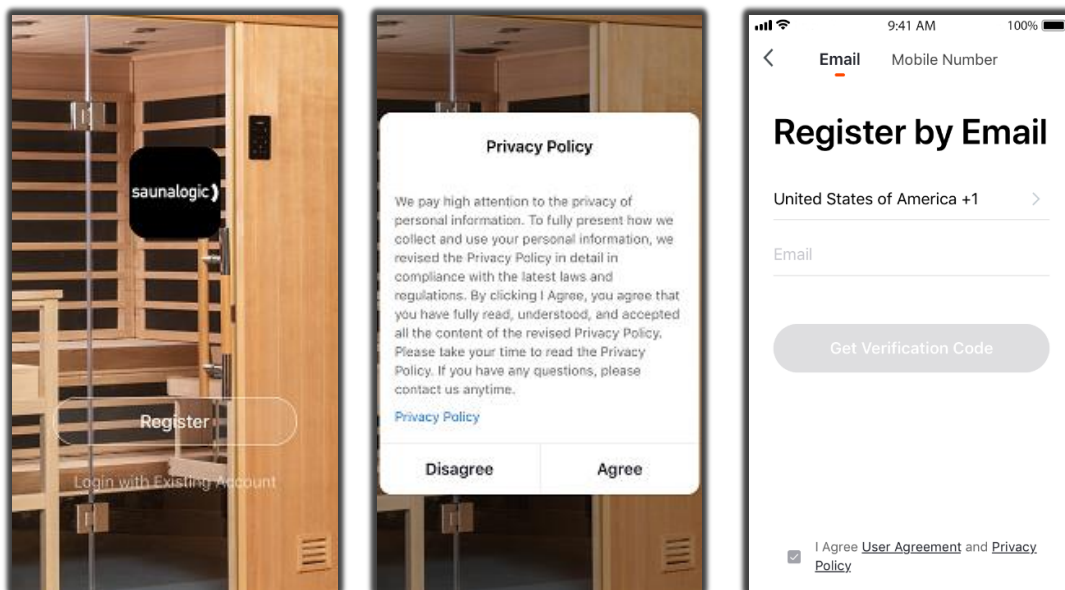

3) Login with Your Account: After completing the account registration requirements, you will be able to login with the credentials you provided during that process.

NOTICE: BEFORE MOVING TO THE NEXT STEP (Add Device) YOU WILL NEED TO MAKE SURE THAT THE PHONE OR TABLET THAT YOU ARE GOING TO USE TO PAIR THE SL2 CONTROL TO THE SAUNALOGIC APP IS CONNECTED TO A WIFI NETWORK THAT IS CONFIGURED FOR 2.4GHz AND PROVIDES A STRONG SIGNAL WHERE THE SL2 CONTROL IS LOCATED.

4) Add Device: While on the Home screen, within the SaunaLogic App, Tap on “Add Device” or the Plus Symbol (+) at the top right corner to add a device.

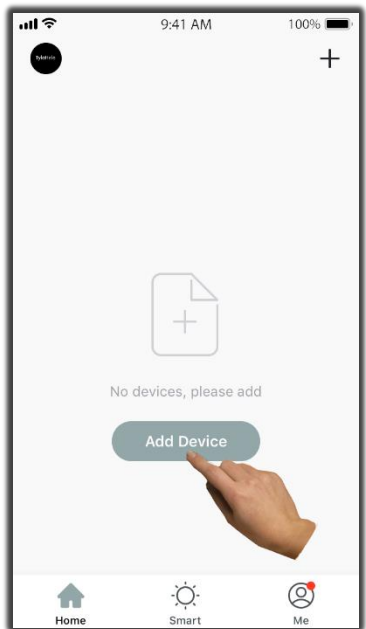

5) Select Sauna: On the Add Manually screen, within the SaunaLogic App, Tap on the Control Icon labeled “Sauna”.

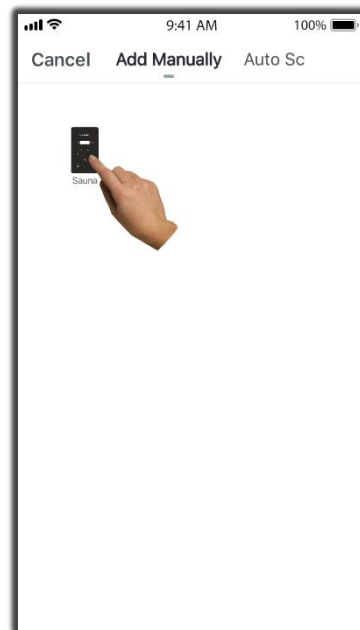

6) Connect to your desired Wi-Fi Network, enter your Password, and then tap on the Confirm Button.

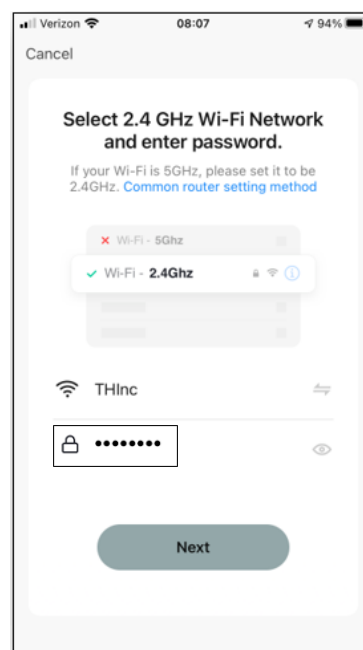
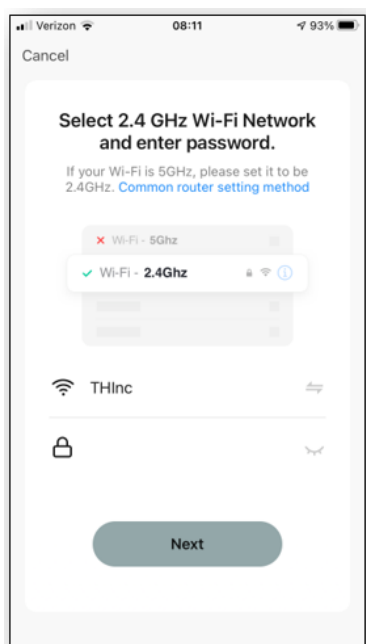

Apple Device Pairing Instructions:

7) Put the SL2 Control into pairing state by pressing the Bluetooth Button until you hear a beep, release, and press & hold again until you hear a second beep and “con” appears on the control display. Then, tap on the ‘**Confirm “Con” is Control**’ Button within the SaunaLogic App and then click “**Next**”.

SL2 Control

1. Press & hold Bluetooth button until you hear a beep & then release.

2. Press & hold Bluetooth button again until you hear a 2nd beep & release.

3. SL2 Control should now be in pairing mode.



SaunaLogic App

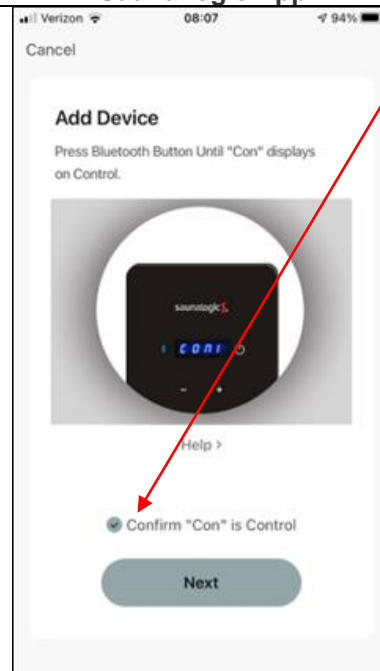

8) Connect your mobile phone to the SL2 Control’s hotspot that is identified in the SaunaLogic App.

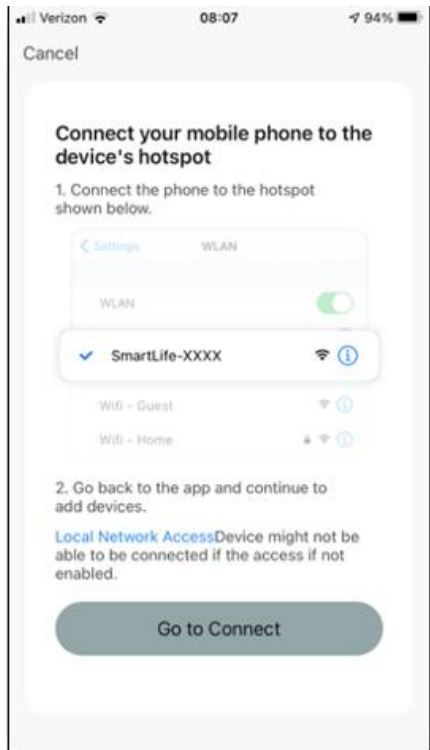

Apple Device Pairing Instructions:

9) Once you have selected and connected to the SL2 Control's hotspot, tap on "SaunaLogic" located at the top left of the screen to go back to the SaunaLogic App and continue with the pairing process.



10) If you get a message that reads "Network is unavailable, please check the network" it means that the connection has failed. Tap "OK" and repeat steps 6 – 9.

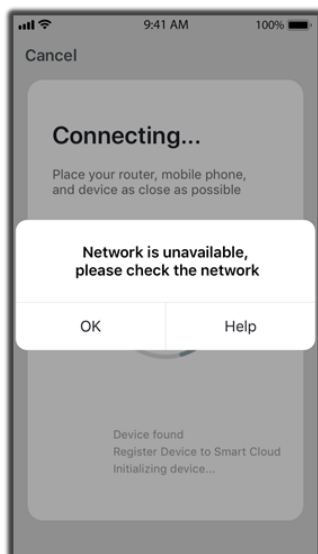

11) If you get a message that reads "Device not responding Check demerit points and retry" it means that the connection has failed. You may need to put the SL2 Control into pairing mode again, and repeat steps 6 – 9.

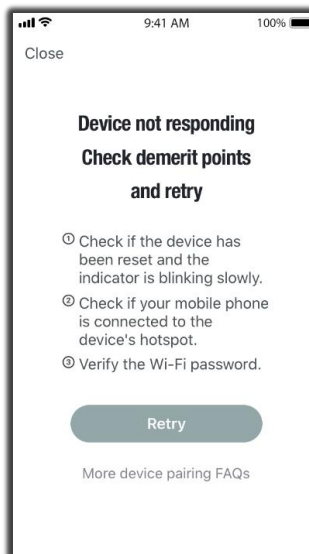

Apple Device Pairing Instructions:

12) Once your SL2 Control successfully connects to the SaunaLogic App, your App screen will pop up with a message stating “Device added successfully” (Figure A) and give you the option to edit the name of your SL2 Control.

You may choose to keep the default name or rename it to something else of your choosing. Keep in mind that it is best to keep this name simple so that if you end up configuring to work with Alexa, Google Assistant or Siri, it will be easier for the smart assistant to understand when you are trying to control the SL2 Control with voice commands.

Tap, “Done” if you decide to keep the default name.

Tap on the  icon if you decide to change the device name. The onscreen keyboard will pop up and allow you to edit the device name (Figure B).

Tap “Save” once you are satisfied with the device name change and then tap “Done”.

Figure A

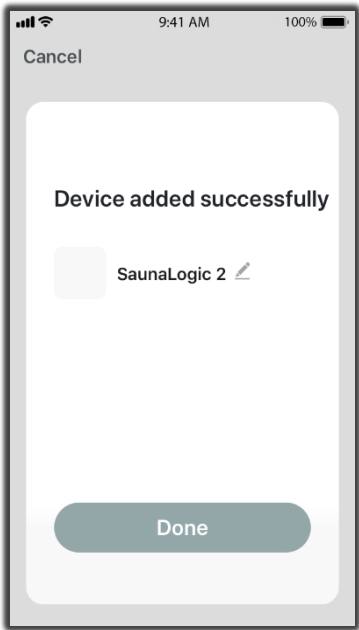
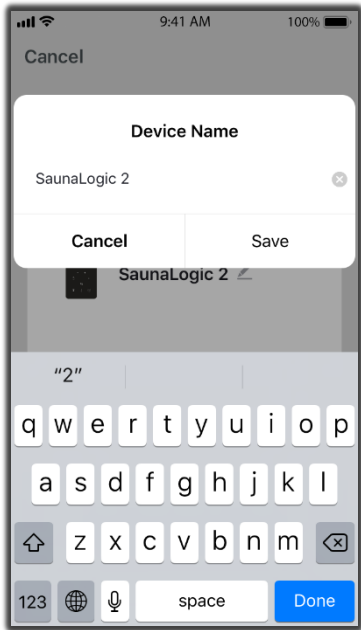



Figure B



Apple Device Pairing Instructions:

13) You should now be able to control your SL2 Control with the SaunaLogic App. Tap the  icon next to the On/Off text on the control screen within the SaunaLogic App to turn your sauna on. You'll find additional control functions that you can adjust here including sauna duration, set temp, etc.



OFF

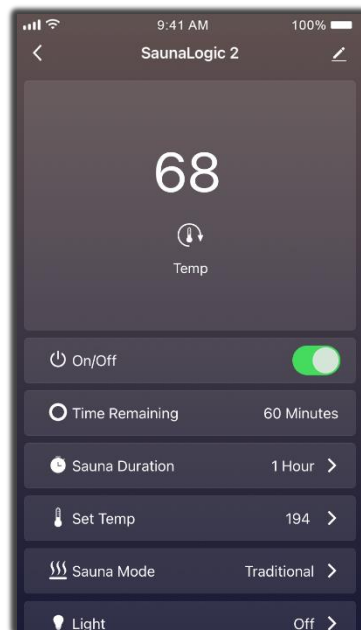

ON

NOTE: THE SAUNA MAY ALSO BE TURNED ON / OFF FROM THE HOME SCREEN BY TAPPING THE  BUTTON, NEXT TO THE SL2 CONTROL ICON (SEE BELOW).

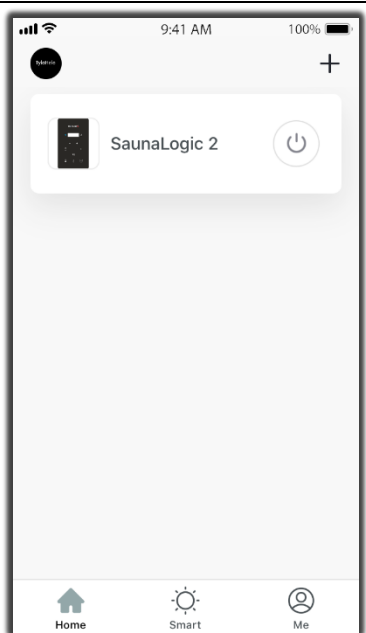

OFF

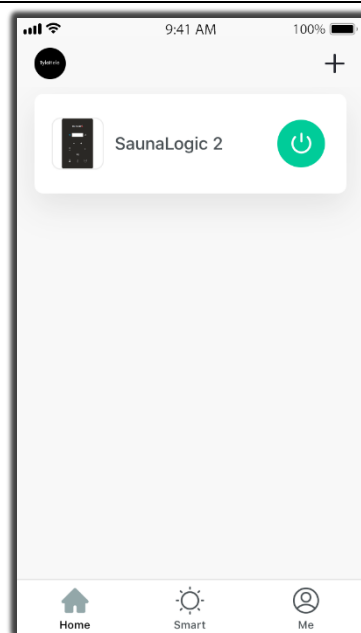

ON

NOTICE: THE SAUNA HEATER AND SL2 CONTROL MUST BE INSTALLED AND OPERATIONAL PRIOR TO PAIRING TO THE SAUNALOGIC APP. REFER TO THE INSTALLATION INSTRUCTIONS SPECIFIC TO THE HEATER MODEL YOU HAVE FOR INSTALL REQUIREMENTS.

1) Download the SaunaLogic App and install onto your smart phone or tablet by scanning the appropriate QR Code below or searching for “SaunaLogic” in the appropriate app store for your smart device.



2) Register a New Account: When you open the SaunaLogic App for the first time, you will be given the option to Register or Login with Existing Account. You will need to select Register and follow the prompts to complete the registration requirements. A valid email address or a mobile phone number will be required to complete the registration process.

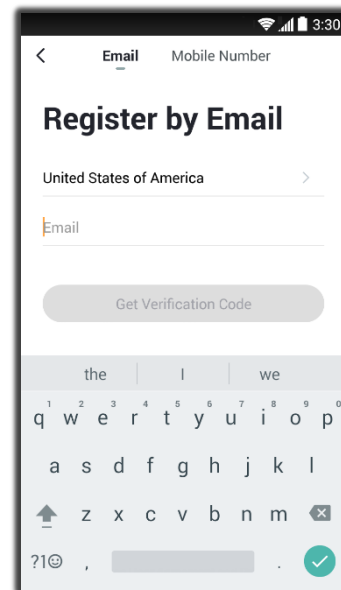
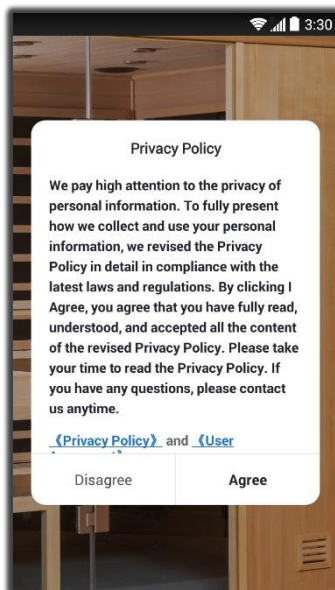

3) Login with Your Account: After completing the account registration requirements, you will be able to login with the credentials you provided during that process.

NOTICE: BEFORE MOVING TO THE NEXT STEP (Add Device) YOU WILL NEED TO MAKE SURE THAT THE PHONE OR TABLET THAT YOU ARE GOING TO USE TO PAIR THE SL2 CONTROL TO THE SAUNALOGIC APP IS CONNECTED TO A WIFI NETWORK THAT IS CONFIGURED FOR 2.4GHZ AND PROVIDES A STRONG SIGNAL WHERE THE SL2 CONTROL IS LOCATED.

4) Add Device: While on the Home screen, within the SaunaLogic App, Tap on “Add Device” or the Plus Symbol (+) at the top right corner to add a device.

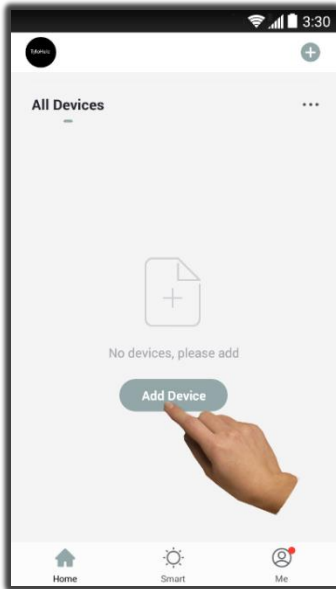

5) Select Sauna: On the Add Manually screen, within the SaunaLogic App, Tap on the Control Icon labeled “Sauna”.

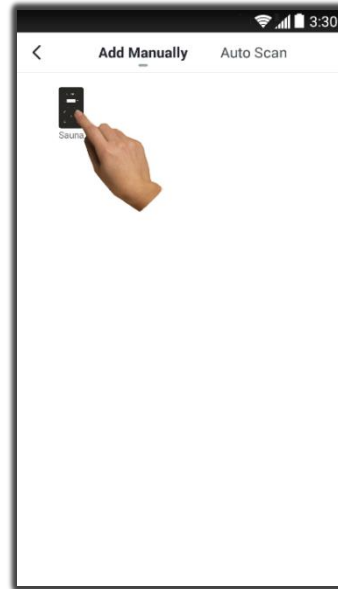

6) Connect to your desired Wi-Fi Network, enter your Password, and then tap on the Confirm Button.

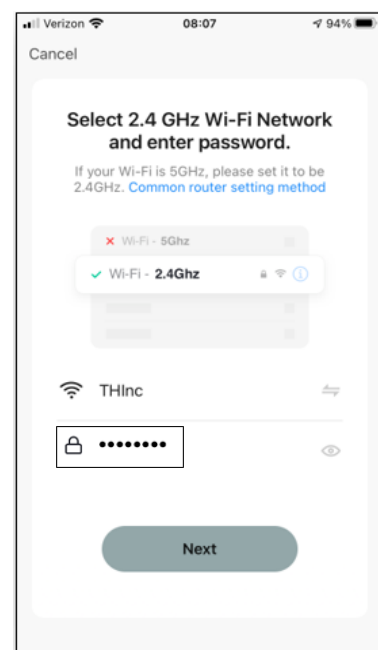
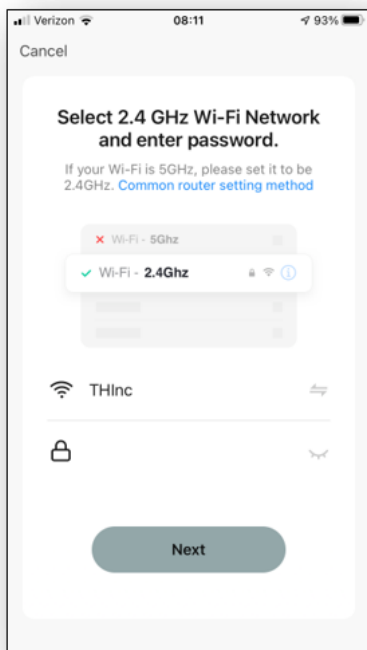

7) Put the SL2 Control into pairing state by pressing the Bluetooth Button until you hear a beep, release, and press & hold again until you hear a second beep and “con” appears on the control display. Then, tap on the ‘**Confirm “Con” is Control**’ Button within the SaunaLogic App and then click “**Next**”.

SL2 Control	SaunaLogic App
<div data-bbox="48 304 381 493" data-label="Text"> <p>1. Press & hold Bluetooth button until you hear a beep & then release.</p> </div> <div data-bbox="48 514 381 745" data-label="Text"> <p>2. Press & hold Bluetooth button again until you hear a 2nd beep & release.</p> </div> <div data-bbox="48 777 381 924" data-label="Text"> <p>3. SL2 Control should now be in pairing mode.</p> </div> <div data-bbox="397 283 803 913" data-label="Image"> </div>	<div data-bbox="998 262 1380 924" data-label="Image"> </div>

8) Connect your mobile phone to the SL2 Control’s hotspot that is identified in the SaunaLogic App.

--	--	--

9) Once you have selected and connected to the SL2 Control’s hotspot, tap the BACK button located at the bottom left of the screen (or with gestures) to go back to the SaunaLogic App and continue with the pairing process.



10) If you get a message that reads “The mobile phone is not connected to Wi-Fi” it means that the connection has failed. Tap “Go to Connect” and repeat steps 6 – 9.

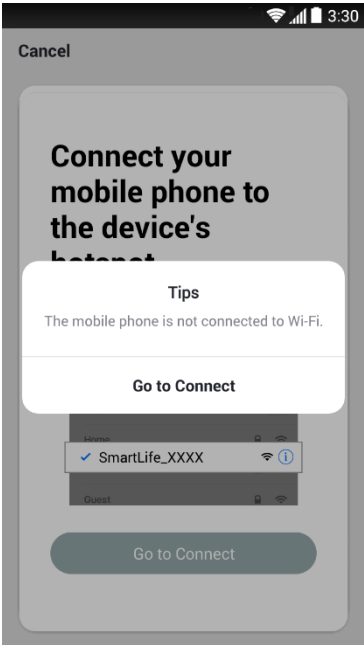

11) If you get a message that reads “Device not responding Check demerit points and retry” it means that the connection has failed. You may need to put the SL2 Control into pairing mode again, and repeat steps 6 – 9.

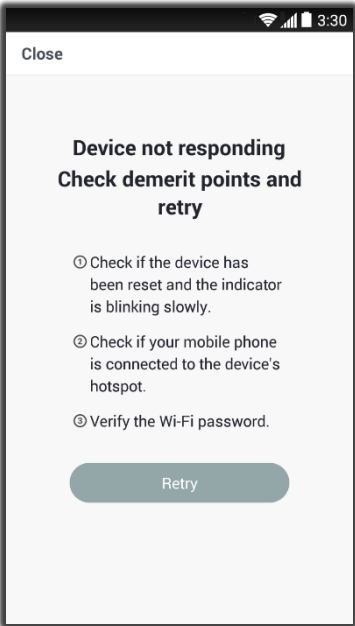

12) Once your SL2 Control successfully connects to the SaunaLogic App, your App screen will pop up with a message stating “Device added successfully” (Figure A) and give you the option to edit the name of your SL2 Control.

You may choose to keep the default name or rename it to something else of your choosing. Keep in mind that it is best to keep this name simple so that if you end up configuring to work with Alexa, Google Assistant or Siri, it will be easier for the smart assistant to understand when you are trying to control the SL2 Control with voice commands.

Tap, “Done” if you decide to keep the default name.

Tap on the  icon if you decide to change the device name. The onscreen keyboard will pop up and allow you to edit the device name (Figure B).

Tap “Save” once you are satisfied with the device name change and then tap “Done”.

Figure A

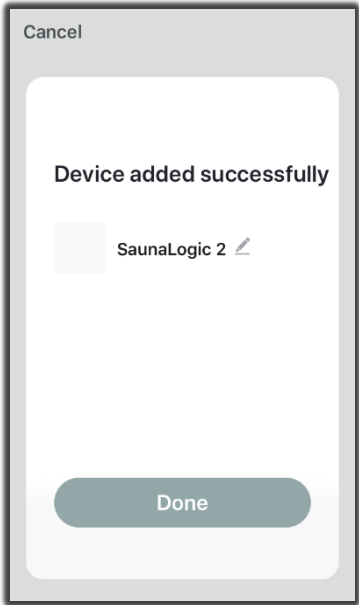
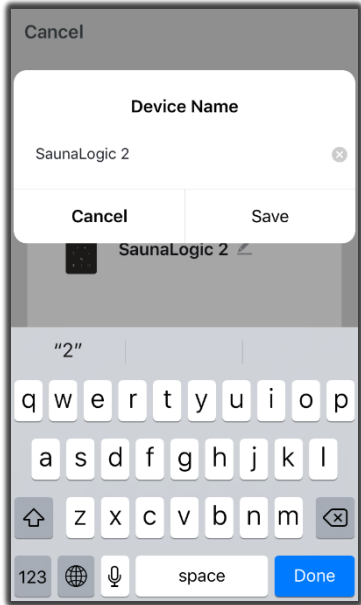



Figure B



13) You should now be able to control your SL2 Control with the SaunaLogic App. Tap the  icon next to the On/Off text on the control screen within the SaunaLogic App to turn your sauna on. You'll find additional control functions that you can adjust here also including sauna duration, set temp, etc.

	
OFF	ON

NOTE: THE SAUNA MAY ALSO BE TURNED ON / OFF FROM THE HOME SCREEN BY TAPPING THE  BUTTON, NEXT TO THE SL2 CONTROL ICON (SEE BELOW).

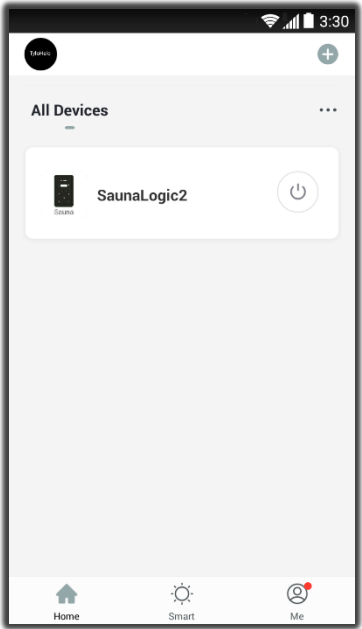
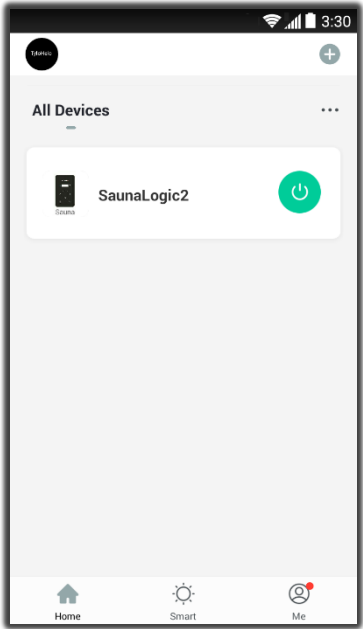
	
OFF	ON